

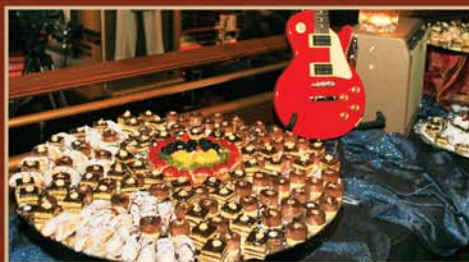

Secure Your Place In Rock History



Private Parties/Corporate Meetings and Events/Cocktail Receptions  
**MULTIPLE EVENT SPACES AVAILABLE FOR PARTIES UP TO 800 PEOPLE**



**BALTIMORE • 601 E. PRATT STREET • 410-347-ROCK • HARDROCK.COM**

# MEET • GREET • ROCK • PARTY

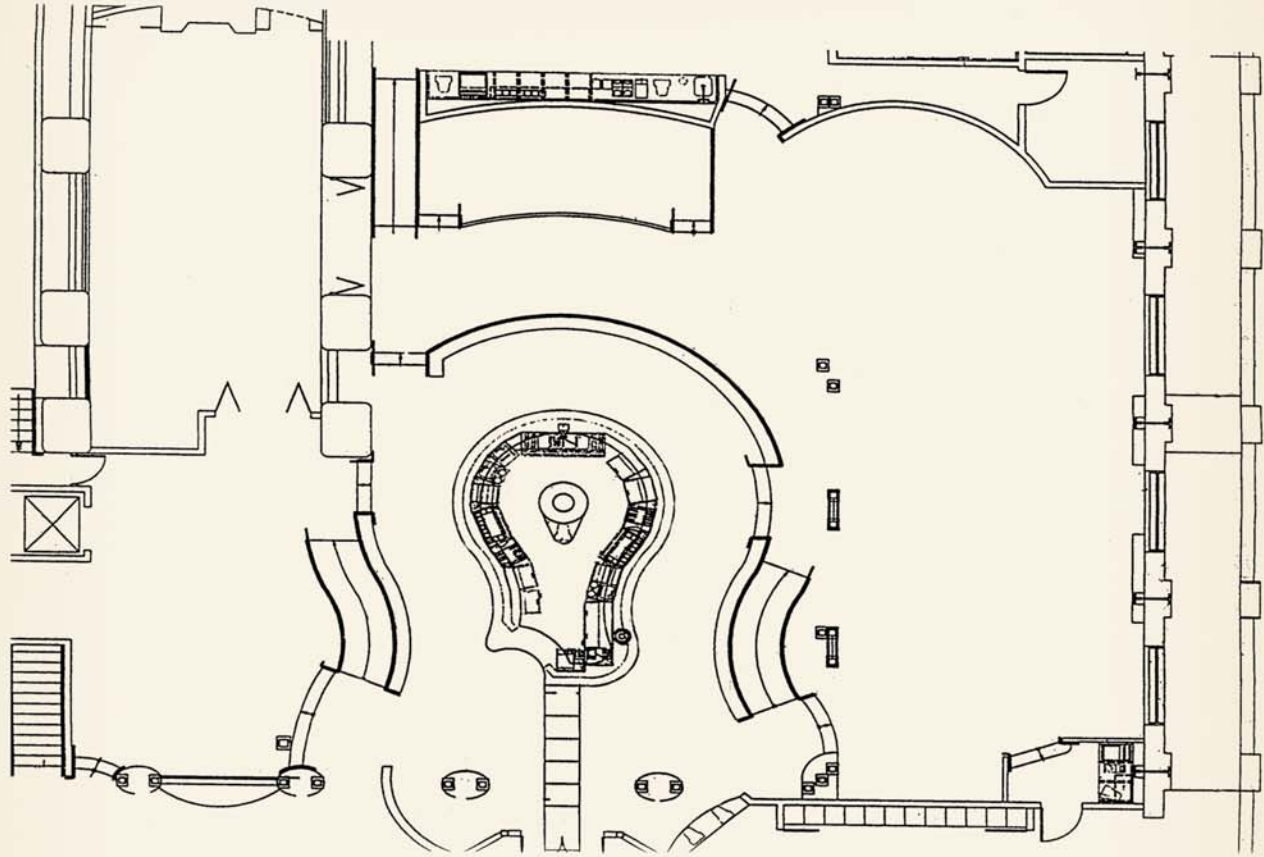

## CAFE CAPACITY

	Seated at Tables	Reception Style	Conference Style
BEATLES' PRIVATE LIBRARY	Up to 40 ppl.	Up to 50 ppl.	Up to 25 ppl.
BEATLES' PRIVATE LIBRARY & DEN AREA	Up to 92 ppl.	Up to 120 ppl.	
HARBOR SIDE AREA	Up to 136 ppl.	Up to 200 ppl.	Up to 100 ppl.
OUTDOOR PIER	Up to 125 ppl.	Up to 220 ppl.	
VENUE BUYOUT	Up to 250 ppl.	Up to 450 ppl. (Inside) Up to 800 ppl. (With Outside Pier Flow Basis)	

## AUDIO VISUAL CAPABILITIES\*

- Stage Dimension: 20' long x 7' wide
  - Stage Lighting Included
  - Speech Sound System (Wired Microphone & Stand)
  - Projector (data/DVD/VHS)
  - Wireless Lavalier or Microphone
  - Standing and/or Tabletop Podium
  - 24" TV Monitor with Stand
  - DVD Player
  - VHS Player
- Private Room:
- Flat Screen Monitor
  - Internet & Phone Hook Up
  - Controlled Sound System Separate from the In-House Sound System

\*Applicable fees apply.

## BOOKING INFORMATION

We are a full service event planning facility with state of the art audiovisual options available for all events. Catering, entertainment, and event merchandise can be customized to complement every event.

### HARD ROCK CAFE BALTIMORE

601 E. PRATT STREET, BALTIMORE, MD 21202

PHONE 410-347-ROCK • EMAIL US AT BALTIMORE\_SALES@HARDROCK.COM