

Making its debut soon, Hard Rock Las Vegas Hotel & Casino will be a fully integrated luxury resort offering world-class gaming, dining and entertainment, all located centerstage on the Strip. Anchored by a nearly 700-foot guitar-shaped hotel, the resort will offer nearly 200,000 sq. ft. of flexible, pillarless, carpeted meeting space. With events conveniently located on the same level as the main hotel, your attendees will have easy access, just a quick, three-minute walk from their guestrooms.

The stage is being set for the ultimate meeting & event experience at Hard Rock Las Vegas, where business and leisure will come together like never before. Secure your space now and be among the first to step into the spotlight.

COMING SOON

LAS VEGAS

HARD ROCK HOTEL & CASINO



## THE PLACE TO GET DOWN TO BUSINESS

3400 Las Vegas Boulevard South, Las Vegas, Nevada, 89109, USA . [groupsales@hrhclasvegas.com](mailto:groupsales@hrhclasvegas.com)

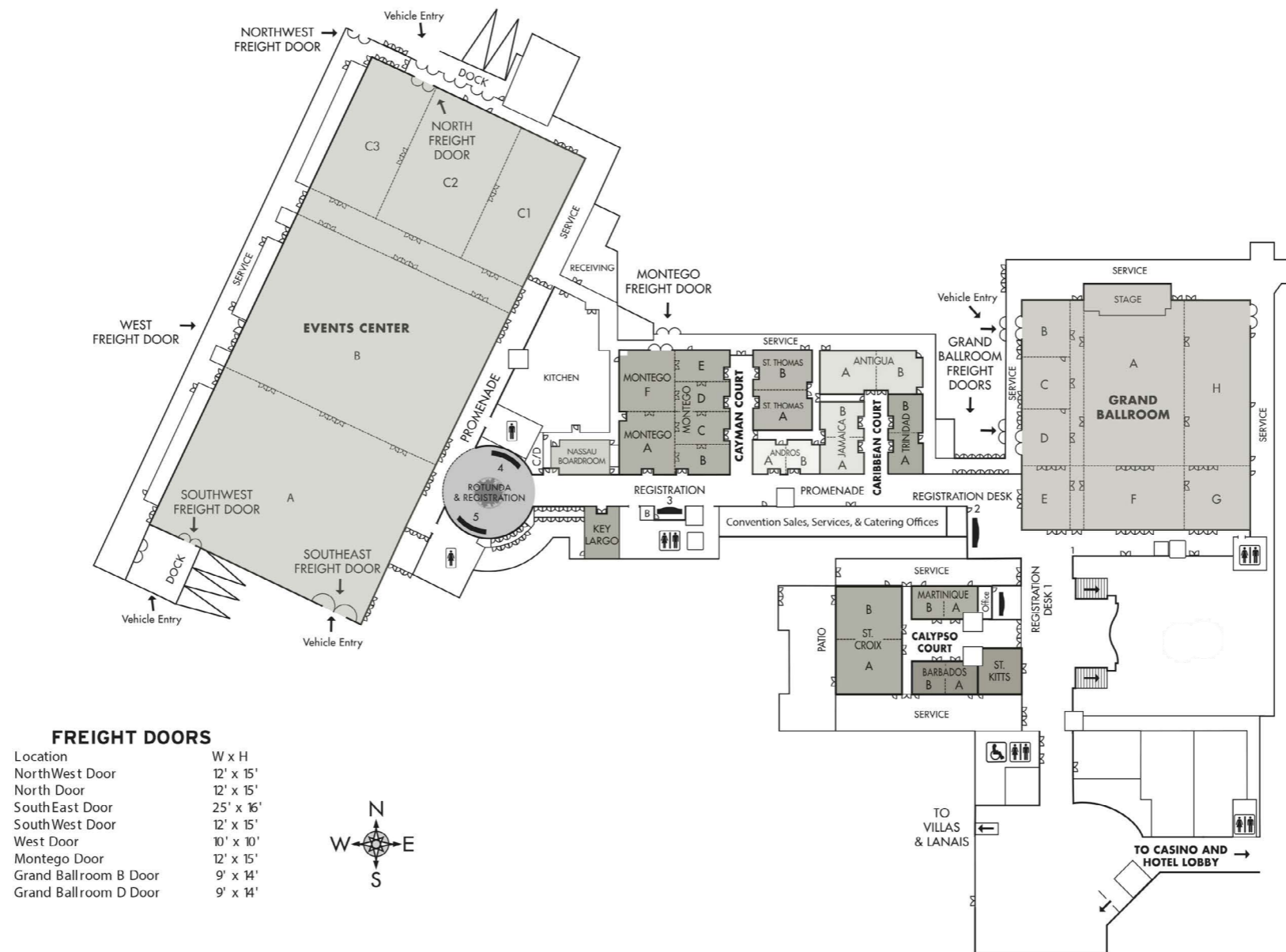

# LAS VEGAS

hard rock hotel & casino



## THE PLACE TO GET DOWN TO BUSINESS

3400 Las Vegas Boulevard South, Las Vegas, Nevada, 89109, USA . [groupsales@hrhclasvegas.com](mailto:groupsales@hrhclasvegas.com)

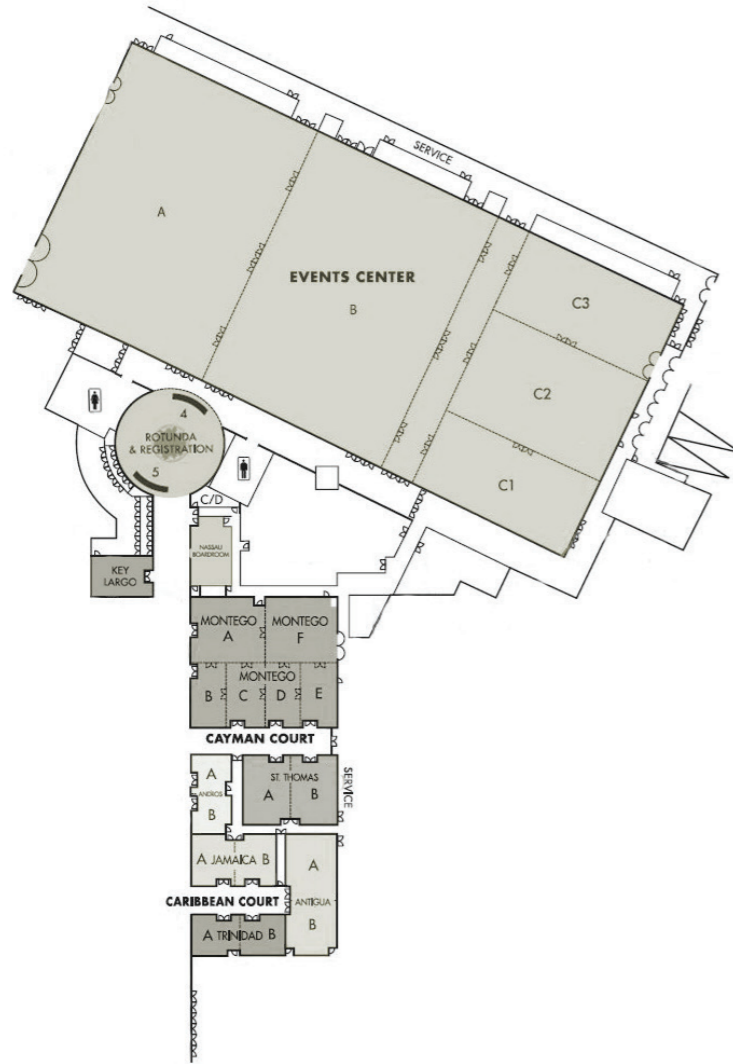

room	dimensions	sq. ft.	ceiling	theatre	school room	hollow sq.	u-shape	conference	cocktail reception	banquet	8 x 10 exhibits	10 x 10 exhibits
events center	447 x 200	89,567	30'	9,000	5,375	—	—	—	6,000	5,800	540	508
events center a	148 x 200	29,750	30'	3,100	1,535	—	—	—	2,100	1,820	180	165
events center b	150 x 200	30,000	30'	3,100	1,535	—	—	—	2,100	1,820	180	165
events center c	148 x 200	29,750	30'	3,100	1,535	—	—	—	2,000	1,820	180	165
events center c1	118 x 55	5,937	30'	700	420	125	110	—	435	340	40	32
events center c2	118 x 90	10,687	30'	1,020	540	160	125	—	720	650	67	58
events center c3	118 x 55	5,937	30'	700	420	125	110	—	435	340	40	32
events center c1-c3	118 x 200	23,750	30'	2,600	1,280	—	—	—	1,590	1,450	140	115
rotunda	—	5,027	—	—	—	—	—	—	—	—	—	—
montego	103 x 92	9,844	20'	975	490	140	115	95	650	560	52	40
montego a	47 x 49	2,324	20'	230	125	65	55	50	160	130	—	—
montego b	26 x 49	1,181	20'	125	70	40	30	35	80	60	—	—
montego c	28 x 44	1,254	20'	145	85	50	40	35	85	60	—	—
montego d	28 x 44	1,254	20'	145	85	50	40	35	75	60	—	—
montego e	27 x 49	1,129	20'	135	75	40	35	35	80	60	—	—
montego f	53 x 47	2,412	20'	230	125	65	55	50	160	140	—	—
andros a & b	59 x 27	1,588	14'	140	80	60	55	50	105	90	—	—
andros a	28 x 27	751	14'	60	30	30	25	25	50	40	—	—
andros b	30 x 27	837	14'	65	35	35	25	25	55	40	—	—
st. thomas a & b	70 x 47	3,378	16'	370	195	90	70	60	275	200	—	—
st. thomas a	31 x 47	1,715	16'	165	100	50	45	40	115	100	—	—
st. thomas b	32 x 47	1,663	16'	165	100	50	45	40	120	90	—	—
jamaica a & b	63 x 34	2,193	14'	215	110	65	55	55	175	120	—	—
jamaica a	30 x 34	1,147	14'	110	55	40	30	30	90	60	—	—
jamaica b	32 x 34	1,046	14'	95	55	40	30	30	65	50	—	—
trinidad a & b	70 x 27	1,947	14'	185	95	70	60	60	165	100	—	—
trinidad a	35 x 27	959	14'	90	45	35	30	25	65	50	—	—
trinidad b	35 x 27	988	14'	95	50	35	30	25v	65	50	—	—
antigua a & b	90 x 37	3,173	16'	370	190	95	85	80	230	200	—	—
antigua a	47 x 37	1,683	16'	170	90	50	45	40	140	100	—	—
antigua b	43 x 37	1,490	16'	150	85	45	40	35	100	100	—	—
nassau boardroom	59 x 31	1,829	12'6"	—	—	—	—	24	—	—	—	—
key largo	37 x 31	1,273	14'	100	60	40	30	35	85	60	—	—

# LAS VEGAS

hard rock hotel & casino



## THE PLACE TO GET DOWN TO BUSINESS

3400 Las Vegas Boulevard South, Las Vegas, Nevada, 89109, USA . [groupsales@hrhclasvegas.com](mailto:groupsales@hrhclasvegas.com)

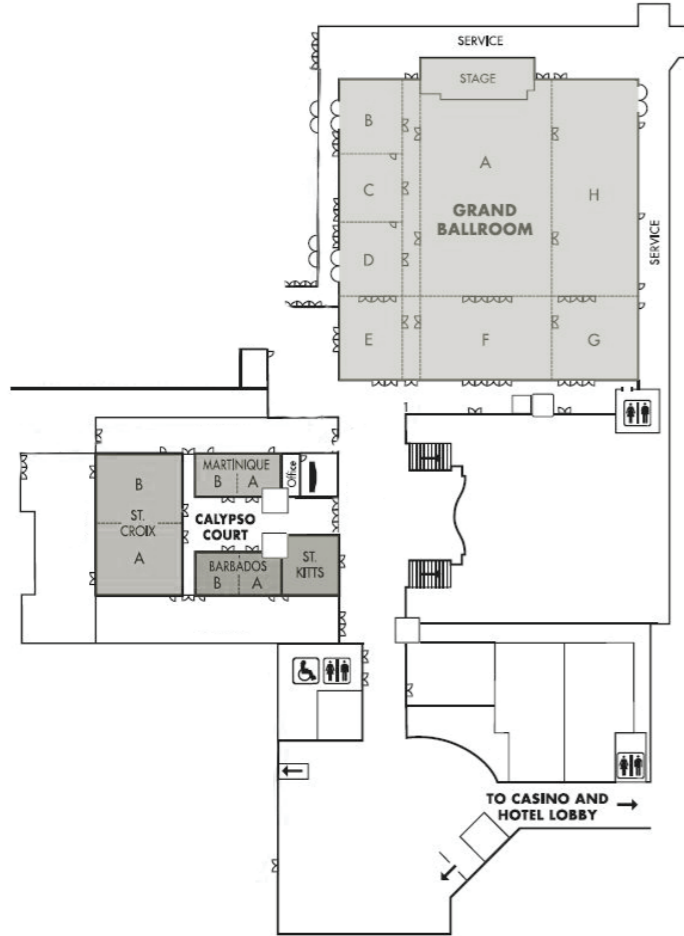

room	dimensions	sq. ft.	ceiling	theatre	school room	hollow sq.	u-shape	conference	cocktail reception	banquet	8 x 10 exhibits	10 x 10 exhibits
grand ballroom	199 x 200	39,552	24'	4,680	2,520	—	—	—	2,700	2,380	245	210
grand ballroom a	135 x 88	12,011	24'	1,130	655	140	110	110	900	760	70	65
grand ballroom b	45 x 44	1,980	24'	170	100	55	45	35	130	100	10	10
grand ballroom c	45 x 44	1,980	24'	240	100	55	45	35	130	100	10	10
grand ballroom d	49 x 44	2,156	24'	240	120	60	45	40	140	110	10	10
grand ballroom e	59 x 44	2,640	24'	290	145	70	55	50	180	150	12	12
grand ballroom f	59 x 88	5,280	24'	430	300	100	80	70	360	300	26	26
grand ballroom g	59 x 55	3,360	24'	285	165	70	55	50	225	200	17	13
grand ballroom h	139 x 55	7,784	24'	840	400	110	100	110	520	420	45	32
recessed stage	78 x 34	2,652	—	—	—	—	—	—	—	—	—	—
st. croix a & b	90 x 48	4,534	17'	435	255	90	80	60	310	260	—	—
st. croix a	45 x 58	2,269	17'	245	115	45	40	30	150	120	—	—
st. croix b	45 x 48	2,265	17'	245	115	45	40	30	150	120	—	—
barbados a & b	60 x 29	1,709	12'	190	95	70	60	50	120	100	—	—
barbados a	30 x 29	859	12'	80	45	30	25	25	60	40	—	—
barbados b	30 x 29	850	12'	80	45	30	25	25	60	40	—	—
martinique a & b	60 x 29	1,709	12'	190	95	70	60	50	120	100	—	—
martinique a	30 x 29	859	12'	80	45	30	25	25	60	40	—	—
martinique b	30 x 29	850	12'	80	45	30	25	25	60	40	—	—
st. kitts	39 x 28	1,112	12'	120	60	40	35	30	80	60	—	—

*The addition of head tables, audio/visual equipment, dance floors, staging, catering and other equipment will affect capacities. Banquet capacities are based on 72" rounds of 10. All convention space is located on the ground level.*

# LAS VEGAS

hard rock hotel & casino